

HOT YOGA ROOM AND FULL SPECTRUM SAUNA
Designed with two commercial grade mahogany 4.5" removable benches. Use it as your own private hot yoga room or a full spectrum infrared sauna.

BUILT-IN CHARGING AND AUDIO STATION
Charge your tablet or smart-phone inside the sauna and connect your favorite audio device with Bluetooth or the included MP3 jack.

BEAUTIFUL ACCENT LIGHTS
Energy efficient LED lights highlight the beauty of your sauna while providing gentle ambient lighting.

COMBINATION DOOR HANDLE/TABLET CRADLE FOR EASY MEDIA VIEWING
Place your tablet on the door handle for easy viewing of your favorite shows or movies from inside the sauna.

DOUBLE CHROMOTHERAPY
Two banks of 96 LED lights, 12 colors to choose from, 3 levels of intensity and comes with a remote

ITALIAN DESIGNED SAUNA WITH GLASS ROOF
The modern look of your Sanctuary Professional sauna will compliment every room.

THERAPEUTIC FAR INFRARED HEATERS
Our exclusive True Wave® combination carbon/ceramic low EMF / low ELF heaters surround you in healing infrared heat.

700 WATT TRUE WAVE FULL SPECTRUM HEATERS
Our full spectrum near, mid and far infrared heaters deliver over 20 times the power of the nearest leading competitor. Our patented heating system allows for the deepest penetration with peak performance for the best results.

SOLID WOOD REMOVABLE FLOOR
Plenty of room for Yoga poses and easy to maintain and replace.

ADDITIONAL DOOR HINGE FOR STABILITY

ENHANCED AUDIO SOUND SYSTEM



Bluetooth and AUX inputs makes it easy to connect and listen to your audio devices.

DIGITAL KEYPAD CONTROLS



Never Fail™ digital keypad controls temperature, time, lights, heater intensity and reservation mode.

COLOR LIGHT THERAPY



Your Sanctuary sauna comes standard with our healing Chromotherapy. Choose from one of twelve colors or auto-cycle through all color tones.

TABLET / SMARTPHONE CONTROL (optional)



Log in from your Android tablet or smartphone and remotely operate your sauna.

Construction

Mahogany Exterior/Interior
Removable Floor
Solid Wood Removable Bench
Tongue & Groove Construction
Weight: 715 lbs

Exterior

Width: 76"
Depth: 60"
Height: 77"
Door: 23 3/4" x 73 1/4"

Interior

Width: 71"
Depth: 56"
Height: 74"
Two Benches:
35" x 22"
Bench Height: 20"

Heaters

True Wave® Carbon/Ceramic
Far infrared and 2 x 700 Watt
full spectrum heaters
Power: 240V or 208V / 20AMP

5 Year Commercial Warranty

Cabinetry & Glass
Electrical
Heaters
Controls

SPECIFICATIONS

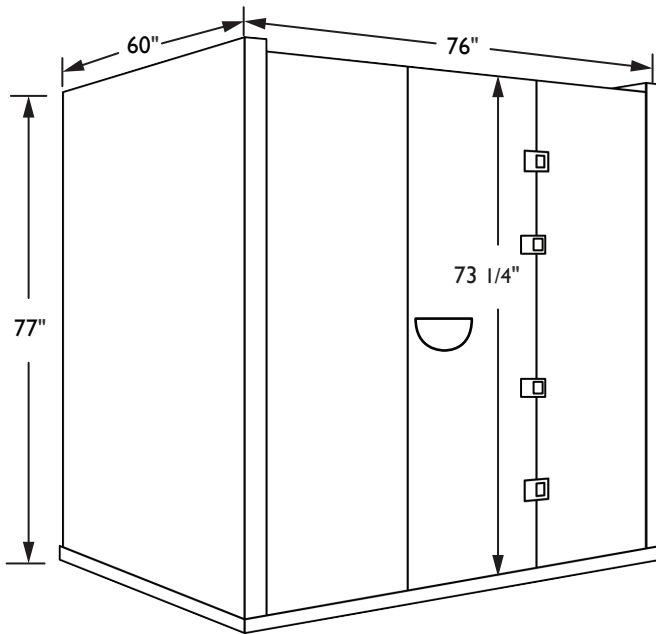

Top View

Power Supply is located on the top of the sauna.
The cord is approximately 8 feet long.

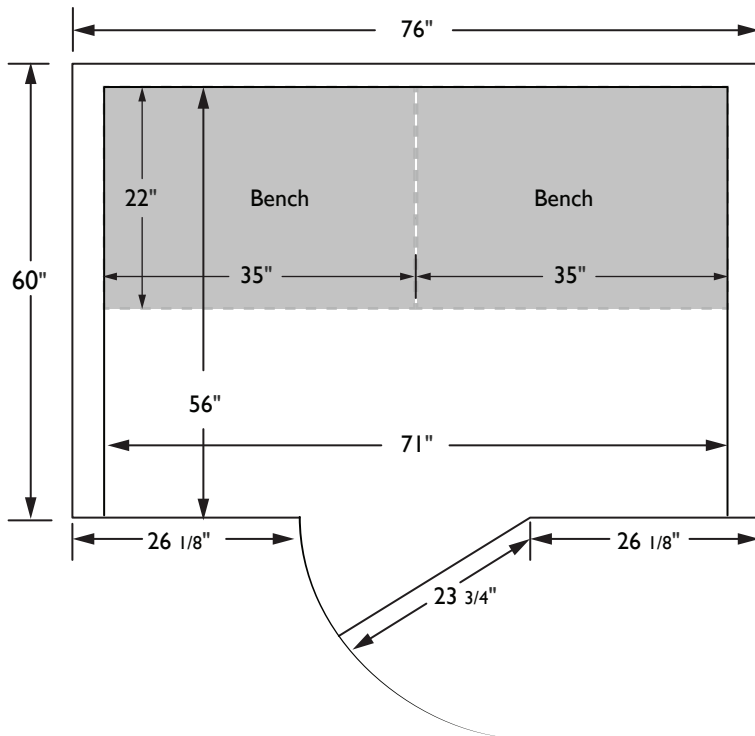
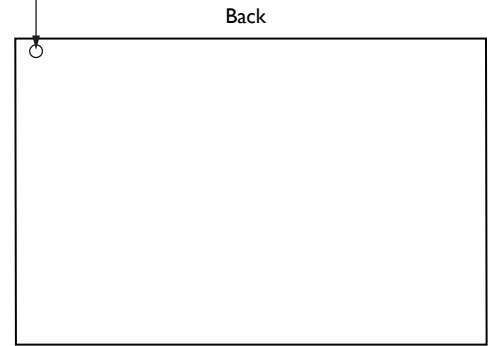

240volt / 20 amp NEMA 6-20 Plug

